

Dallas County Courthouse Court Facility Needs Presentation

Presentation to the Dallas County Board of Supervisors
By Christopher T. Patterson
Fifth Judicial District Court Administrator

October 17, 2017

Existing Conditions vs. Modern Design Guidelines and Operating Standards



EXISTING COURTHOUSE LACKS...

- Sufficient courtroom capacity for current workload and future judgeship apportionment
- Modern adjacency and circulation design considerations or courthouse stacking concepts
- Separate zones of circulation
- Waiting area for victims, witnesses & children
- Private attorney-client conference rooms
- Secure movement of in-custody defendants
- Configuration which optimizes efficiency & security

Dallas County Population Projection (2016 – 2046)

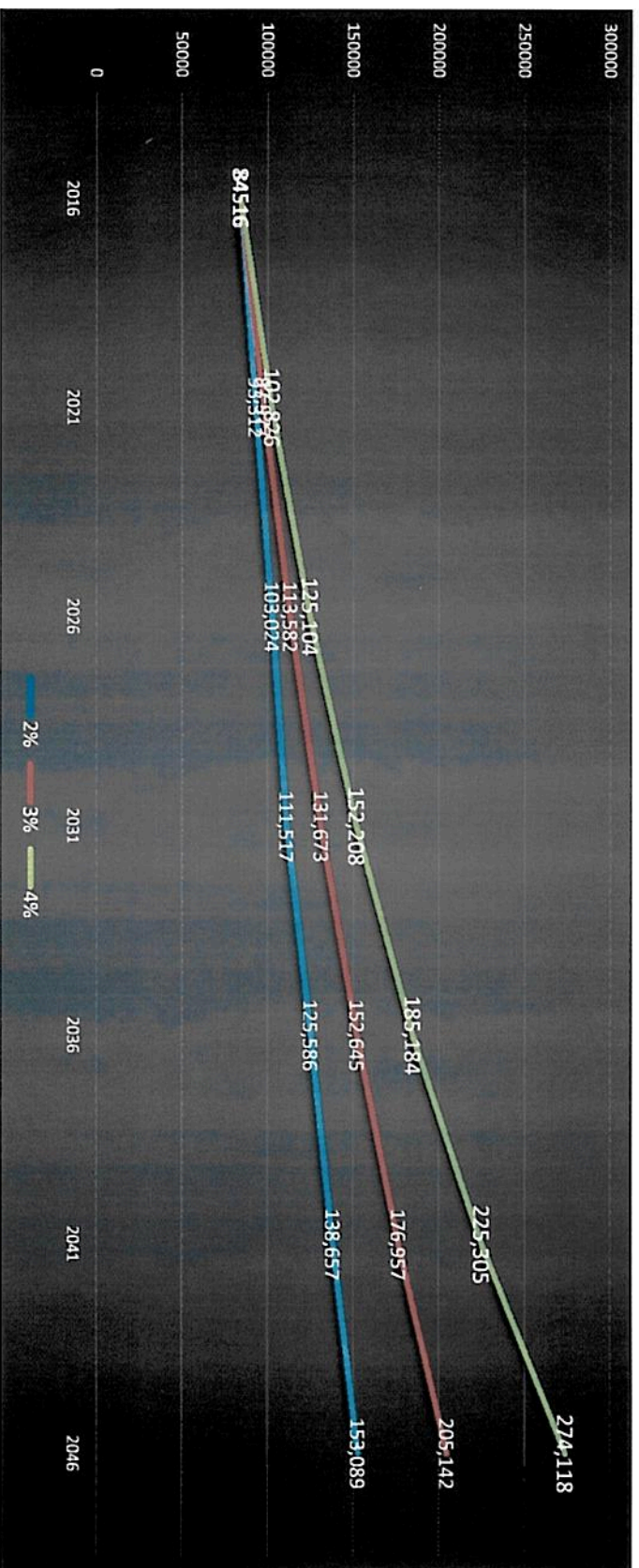

2016 Figure cites the U.S. Census Bureau's published population estimate for Dallas County, Iowa at 84,516.

Statutes Governing Number & Apportionment of Judgeships

- The number of judgeships is determined in **three** ways:

District Court Judgeships

- The number of district court judgeships is prescribed by a formula in Iowa Code Section 602.6201, but capped statutorily at 116 (Section 602.6201(10)) The formula is based on population and the number of civil and criminal filings.

District Associate Judgeships

- Iowa Code Section 602.6301 provides an apportionment formula based on county population as follows:
 - 1 district associate judge for counties having populations of 35,000 to 80,000
 - 2 district associate judges for counties having population of 80,000 to 125,000
 - 3 district associate judges for counties having population of 125,000 to 170,000
 - 4 district associate judges for counties having population of 170,000 to 215,000
 - 5 district associate judges for counties having population of 215,000 to 260,000
 - 6 district associate judges for counties having population of 260,000 to 305,000
- Iowa Code Section 602.6302 allows for the conversion of three judicial magistrate judgeships into one district associate judgeship.

Dallas County Comparison to Benchmark Counties

	2016 Population Estimates*	Judges / DAJs	Jury vs. Non-jury Courtrooms	Clerk & Court Support Staff <u>NEEDED</u> per 2017 Workload Formula*
Linn County	221,661	5 District Judges 6 DAJs	16 Courtrooms 5 Jury 11 Non-jury	51.1
Scott County	172,474	8 District Judges 3 DAJs	11 courtrooms 7 jury 4 Non-jury	49.7
Johnson County	146,547	3 District Judges 2 DAJs	6 Courtrooms * 4 Jury 2 Non-jury (insufficient per DCA)	28.4
Blackhawk County	132,904	8 District Judges 4 DAJs	13 Courtrooms 8 Jury 5 Non-jury	40.5
Woodbury County	102,779	6 District Judges 4 DAJs	11 courtrooms 7 Juried 4 Non-jury	35.4
Dallas County	84,516	2 District Judges 1 DAJ	4 Courtrooms 3 Jury 1 Non-jury	11.8

Source: 2017 NCSC Workload Study of Clerk & Court Support Staff Caseload. Formula based on 3-yr Average Filings

Existing and Projected Need of Judicial Positions and Courtrooms

	Existing	Justified 2017	Projected 2032	Projected 2047
District Court Judges	2	2	4	5
District Court Courtrooms	2	4	6	6
District Associate Judges	1	3	5	7
District Associate Courtrooms	1	3	6	8
Magistrates	1	1	1 - ???	1 - ???
Magistrate Courtrooms	1	1	>1	>1

The number of District Court Judges is prescribed by a formula in Iowa Code Section 602.6201, but is capped statutorily at 116. The formula is based on population and the number of civil and criminal filings.

The number of DAs is determined in two ways. First, Iowa Code Section 602.6301, provides a formula based on county population. Second, Iowa Section 602.6302 allows for the conversion of three magistrates judgeships into one DAJ.

Recommendation 1: Increase courtroom capacity by co-locating Recorder's and Treasurer Office on west wing; construct jury courtroom and magistrate courtroom on east wing.

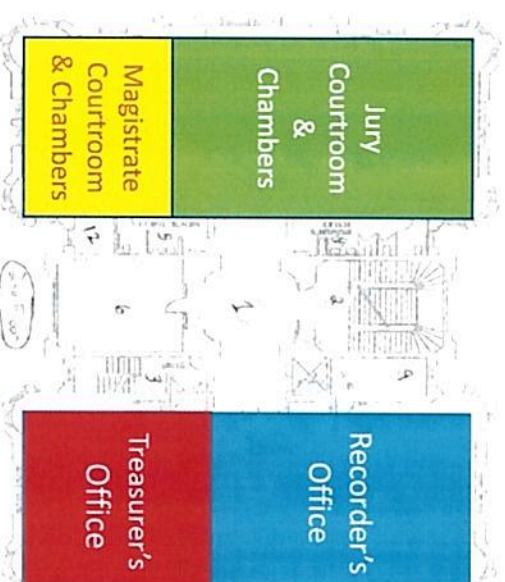
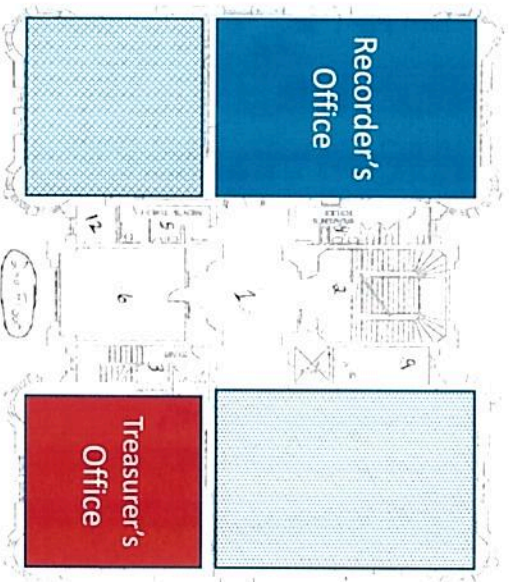

Dallas County Courthouse, 2nd Floor

Recommendation 2: Increase courtroom capacity and improve building circulation and security by constructing an arraignment/hearing courtroom on 1st floor.

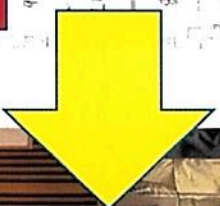

Dallas County Courthouse, 1st Floor

Recommendation 3: Address privacy concerns by converting 2nd floor office space into two private attorney-client conference rooms and semi-private eFiling work stations

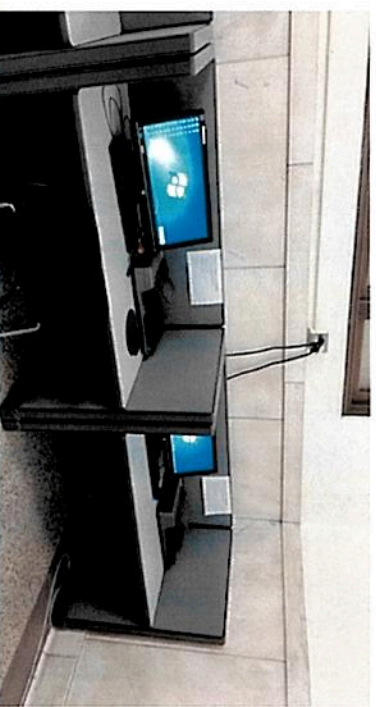
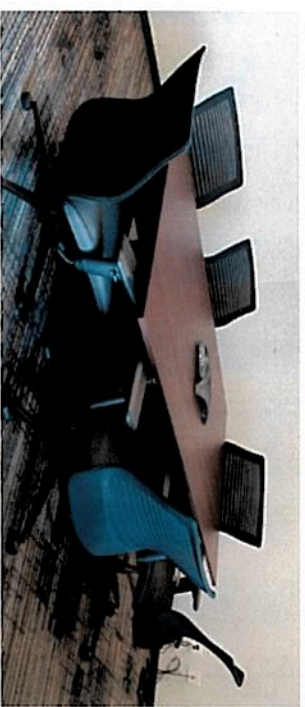
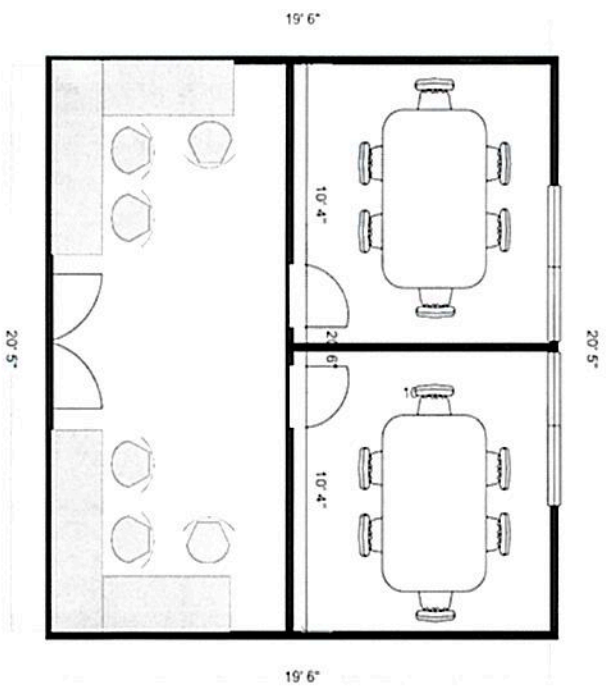

Dallas County Courthouse, 2nd Floor Conference Room

Recommendation 4: Enhance customer service by converting 401 conference room into Victim / Witness Waiting Room.

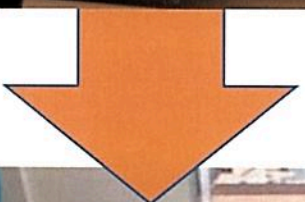

Next Steps

- Continue conversation with court and justice partners
- Funding Options
- Commission feasibility studies ???
- Property acquisition ???
- Criminal Court Facility Design